

1:144 German Berge Panther SdKfz 179 Conversion Kit

(Metal Cable Version)

for intermediate to advance modellers

This conversion set contains 13 parts. The set is designed for converting Takara/Dragon Panthers to Berge Panthers Ausf A or Ausf G. The conversion features a movable anchoring spade; one pulley with hook; one winch cable guide; a set of four cable arrangements to assemble the vehicle in traveling mode, 40 ton extraction mode and 80 ton extraction mode; bumpers and dummy cable connectors. (Modellers might need to remove parts from the chassis to make way for the conversion kit.)

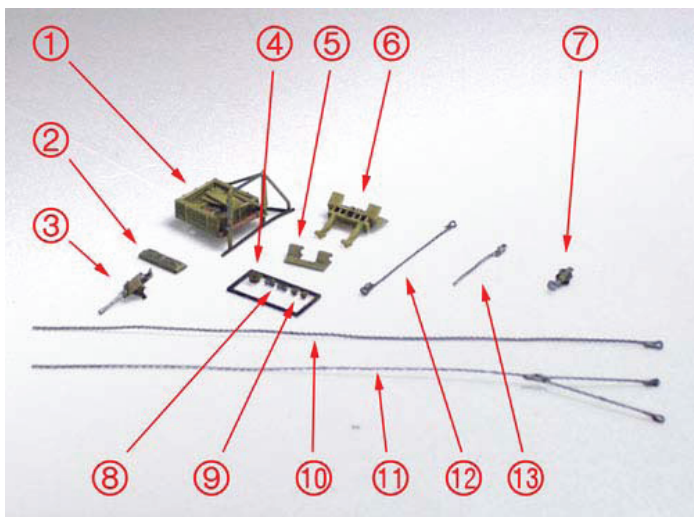

1	Winch housing
2	Crew compartment cover
3	2cm KwK 38
4	Winch cable guide
5	Anchor spade hinge
6	Anchor spade
7	Pulley for 80 ton extraction mode
8	Dummy cable connector
9	Front bumper
10	Winch cable for 80 ton extraction mode
11	Cable assembly for 40 ton extraction mode
12	Tow cable for 80 ton extraction mode
13	Winch cable for travelling mode

The model is made with a strong and flexible Nylon (Game Grade) material. It can withstand a considerable distortion without breaking, sort of like old Airfix plastic soldiers. An ideal material for wargaming vehicles. You do not have to worry about guns breaking up on your gaming table. In case you want to do custom alteration for the vehicle, parts can be glued together with Cyanoacrylate based glue or Super Glue. The material can be painted using regular modelling acrylic paints. It is porous that means it actually absorbs paint into the material so under normal situations the paint

do not crack even when parts are bend.

To learn more about the material or painting go here:
<http://www.combatgroupdynamix.com/index3.html>

1:144 German Berge Panther Conversion Kit is modelled after the BergePanther Ausf A and Ausf G, one of the best recovery vehicle. Ausf D has no winch and have the turret hole covered with wood planks. Extra seats for crew was provided behind the driver and co-driver covered by canvas. (Demonstration photo shows conversion kit applied to Takara Panther hull. Takara Panther hull not included)

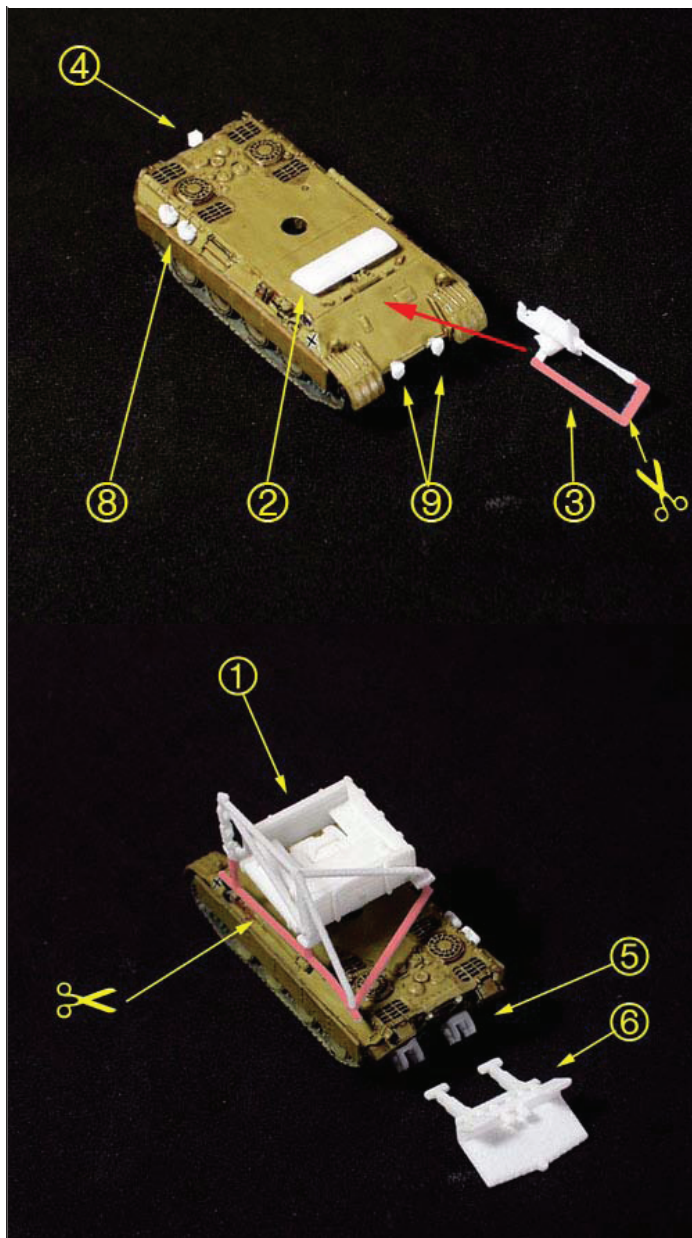

At the heart of the vehicle was a 40 ton winch. On its own the vehicle could provide a 40 ton force to pull out bogged down medium tanks. (Demonstration photo shows conversion kit applied to Takara Panther housing)

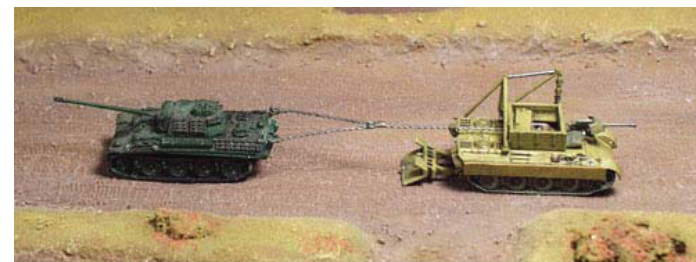

But using a simple block & tackle pulley system, the extraction force could be doubled to 80 ton, enough to pull out disabled heavy tanks. The first pulley of the block and tackle system was cleverly incorporated into the winch mechanism. Operator only required to attach a single pulley looping back the cable to the anchoring spade to complete the system.

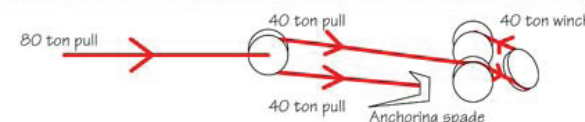
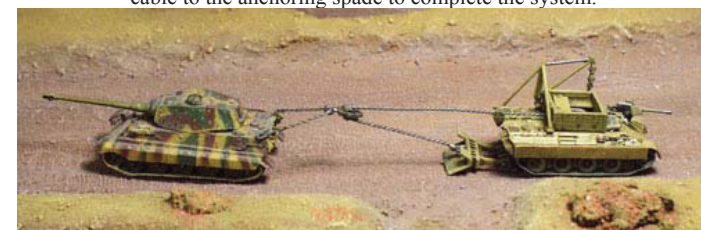

The anchoring spade was of crucial importance in the operation. Without the spade digging deep into the ground, the Berge Panther will be pulled towards the bogged vehicle instead.

When travelling, the winch cable could be used to hold the spade in a raised position.



CG Dynamix
 175B New Trend Plaza, 278-288 King's Rd.
 North Point, Hong Kong
 Tel.: (852) 2359 7694 Fax.: (852) 2782 5685
 Email: mailto:cgdynamix@gmail.com
<http://www.combatgroupdynamix.com>